

Portions of the Northeast 1/4 and Southwest 1/4 of Section 25, Township 36 North, Range 9 East, W.M. in Skagit County, Washington.
(Page 1 of 2 Pages)

122020910 Page 1 of 2 2:11:23AM
Skagit County Auditor
201012200129

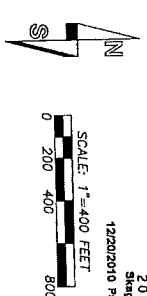

Beats of bearings. True bearings derived from solar observations near the Center-West 1/16th corner of Section 25, Township 36 North, Range 9 East, W.M.

- Found corner as noted
- Set 3/4" aluminum rod with 3" USFS monument
- Set 3/4" aluminum rod with 3" USFS monument "WC"
- ⊕ Calculated position
- Set 1/2" rebar and cap US 36792
- [] GLO bearing and/or distance

Reference surveys:

- 1) GLO survey of T36N-R9E by J.C. Parsons under contract No. 433 (1897)
 - 2) GLO completion survey of T36N-R9E by C.W. Peters, et al under group No. 88 (1923)
 - 3) Report on placement of concrete land survey monuments dated 12/15/2010 by Christopher M. Butler, PLS, at the SW and S 1/4 corners of Section 25, a copy of which was obtained from the PLSD in Olympia, WA
 - 4) Corner card for the W 1/4 corner of Section 25 by the Scott Paper Company, a copy of which was obtained from the PLSD in Olympia, WA
- Method of survey: Closed loop field traverse using a Topcon GTS-220 electronic total station. This survey meets or exceeds precision requirements as set forth in WAC 332-130-090.

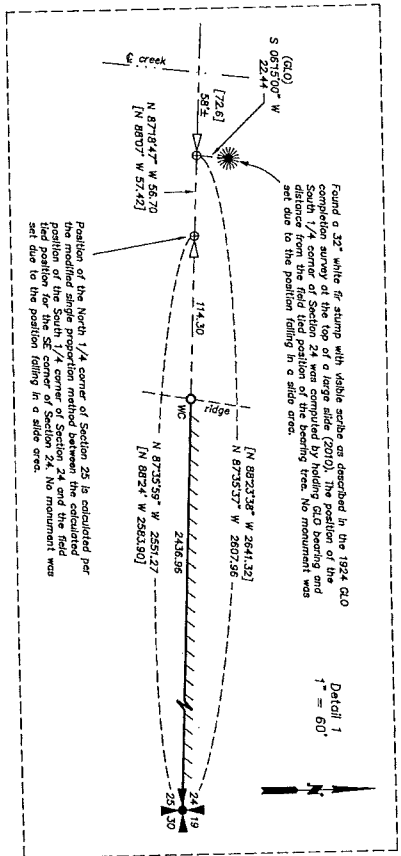
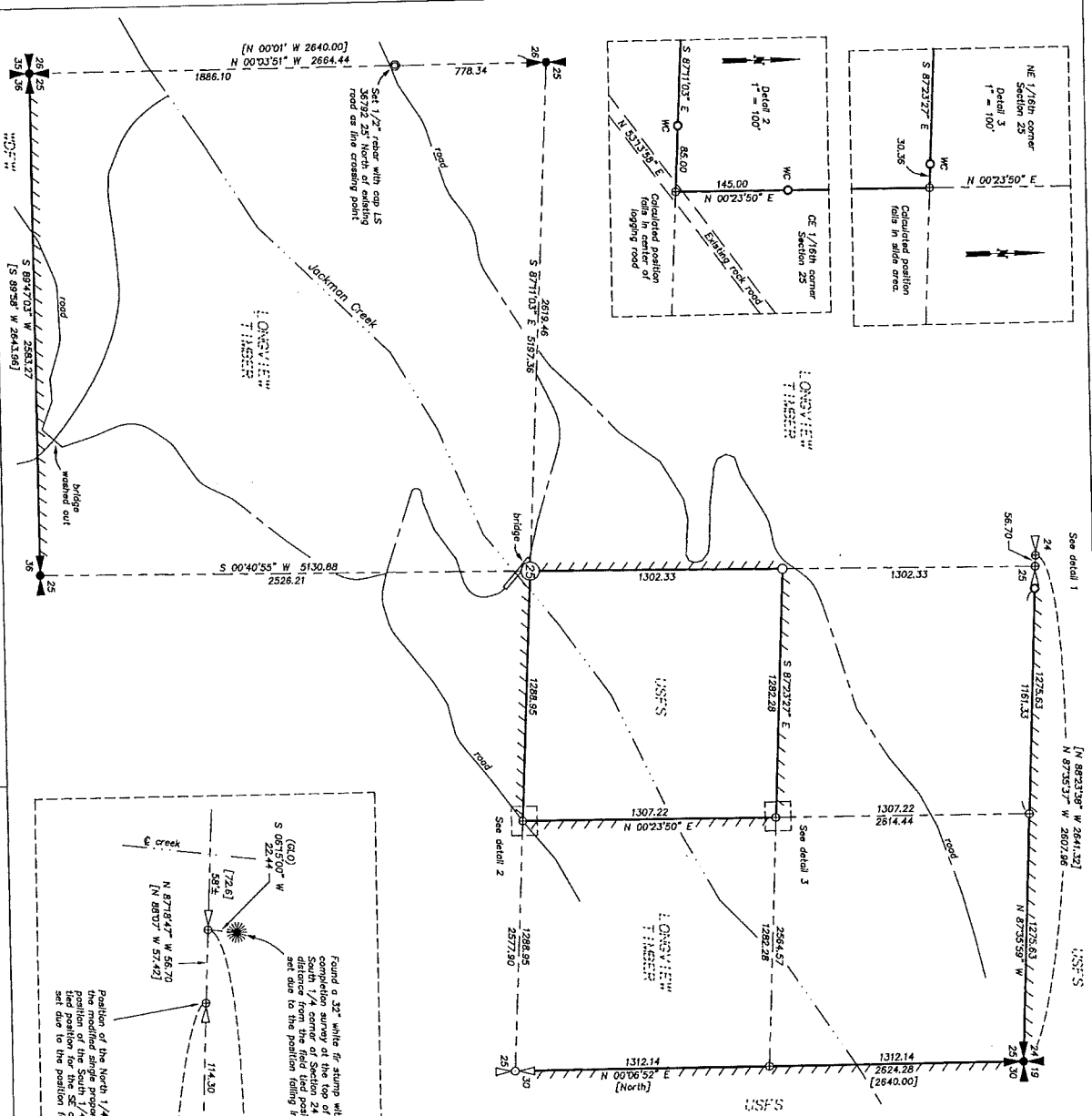

Certificate Number: _____

Auditor's Certificate
Filed for record this 30 day of Dec 2010
at 11:30A in Book 201012200129 Page _____
At the request of Butler Surveying, Incorporated
County Auditor

Record of survey description:

The south line of the Southwest Quarter, the north and east lines of the Northwest Quarter and the exterior boundary of the South West Quarter, all in Section 25, Township 36 North, Range 9 East, W.M. in Skagit County, Washington.

Surveyor's Certificate

This map correctly represents my direction in conformance with the requirements of the Survey Recording Act of the request of Longview Timber Co. and the USFS in December of 2010.

Christopher M. Butler, PLS
Certificate No. 36792



BUTLER SURVEYING INC.
475 NW GREENLASH AVE
360/726-8993
GREENLASH, WA 98826

Drawn	C. Butler	Date	12-9-10
Checked	CS	Job No.	10-55
Scale	1" = 400'	Sheet	1 of 3

Portions of the Northeast 1/4 and Southwest 1/4 of Section 25, Township 36 North, Range 9 East, W.M. in Skagit County, Washington.
 (Page 2 of 2 Pages)

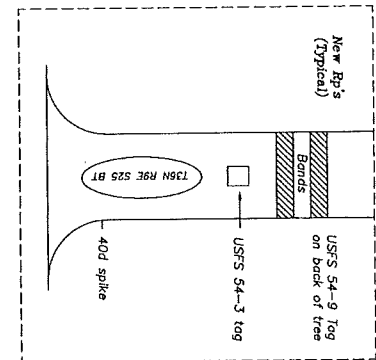

SW corner Section 25-736N-89E

The 1987 GLO survey established the corner as a post with the following bearing trees:

- 10" hemlock N35E 50.87'
- 6" balsam S31W 31.66'
- 6" balsam S31W 31.02'
- 60" hemlock N16W 36.30'

Corner was perpetuated by DNR survey crews in 1987

Evidence found (July of 2010)

- 31" decayed hemlock stump N35E 48.90' (087)
- 31" decayed hemlock stump N18W 48.20' (087)
- 51" decayed hemlock stump with top N35E 22.20' (1987 RP)
- 18" decayed hemlock stump with top S79E 14.30' (1987 RP)

4' x 4' concrete monument with 3" DNR brass disk in top, stamped as shown and the following RP #:

- 18" hemlock N17W 23.70' (scribed 136N R9E S26 B7)
- 16" hemlock S35W 22.40' (scribed 136N R9E S25 B7)
- 10" hemlock S35W 24.10' (scribed 136N R9E S26 B7)
- 10" hemlock S35W 24.10' (scribed 136N R9E S25 B7)
- 10" hemlock S35W 24.10' (scribed 136N R9E S26 B7)

Found 6" iron post with location tag North 5.10'



S 1/4 corner Section 25-736N-89E

The 1987 GLO survey established the corner as a post with the following bearing trees:

- 50" cedar S2630E 13.85'
- 18" hemlock N415W 57.42'

Corner was perpetuated by DNR survey crews in 1987

Evidence found (July of 2010)

- 63" cedar (lim with white ash) S25E 13.20' (087)
- 24" decayed hemlock stump N15W 56.02' (087)

4' x 4' concrete monument with 3" DNR brass disk in top, stamped as shown, exposed 1.2' with orange rodas pined around.

The following accessories were established by this survey:

- 16" hemlock N25W 40.76' (scribed 136N R9E S25 B7)
- Set 1-post 1.0' East of corner.



W 1/4 corner Section 25-736N-89E

The 1987 GLO survey established the corner as a post with the following bearing trees:

- 15" hemlock N45E 34.32'
- 12" hemlock N4015W 31.65'

Evidence found (July of 2010)

- 40" decayed hemlock stump shell with remnants of old face N45E 34.32' (087)
- 20" decayed hemlock stump with no marks, but position
- 9" from slope with PK and in top center bearing N7426E 2.76' from the position established by this survey.

Set a 3/4" aluminum rod with 3" aluminum USFS monument stamped as shown from the above found bearing trees.

The following accessories were established by this survey:

- 14" white fir N89W 28.37' (scribed 1/4 S26 B7)
- 16" white fir N89E 27.74' (scribed 1/4 S26 B7)
- Set steel 1-post 1.0' South of corner

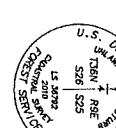

E 1/4 corner Section 25-736N-89E

The 1987 GLO survey established the corner as a post with the following bearing trees:

- 60" hemlock N5715W 23.10'
- 33" fir N7430E 9.24'

Corner was found, but not monumented by DNR survey crews in 1987

Evidence found (July of 2010)

- 20" hemlock stump with visible scar N54W 23.10' (087)
- 50" white fir N74W 23.10' (scribed 1/4 S26 B7)
- 1/2" cedar and cop LS 13516 which bears S371145E 2.65' from the position established by this survey.

Set a 3/4" aluminum rod with 3" aluminum USFS monument stamped as shown from the above found bearing trees.

The following accessories were established by this survey:

- 9" white fir S27E 12.23' (scribed 136N R9E S20 B7)
- 8" white fir S74W 10.20' (scribed 136N R9E S25 B7)
- Set steel 1-post 1.0' North of corner

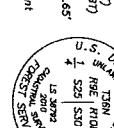

NE Corner Section 25-736N-89E

The 1987 GLO survey established the corner as a post with the following bearing trees:

- 18" hemlock N57E 28.38'
- 20" hemlock S1930E 71.34'
- 18" hemlock S19W 10.56'
- 16" fir N2715W 15.84'

The 1923-24 GLO completion survey confirmed the post and bearing trees and replaced the post with a 1" iron pipe and brass cap

Evidence found (July of 2010)

- 62" hemlock stump with visible scar S71E 71.27' (087)
- 24" decayed hemlock stump with top S10W 16.01' (087)
- 24" decayed hemlock stump N26W 16.01' (087)
- 1" iron pipe with 3" GLO cap stamped as shown

The following accessories were established by this survey:

- 9" white fir N15E 10.62' (scribed 136N R9E S19 B7)
- 8" hemlock N20W 15.26' (scribed 136N R9E S24 B7)
- 33" hemlock S87E 12.15' (scribed 136N R9E S20 B7)

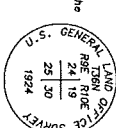

S 1/4 corner Section 24-736N-89E

The 1923-24 GLO completion survey established the corner as a post with the following bearing trees:

- 24" hemlock N5715E 34.32'
- 18" balsam N615E 22.44'

Evidence found (July of 2010)

- 32" white fir stump with visible scar N5715E 22.44'. The 1924 monument and second bearing tree have been destroyed by a slide, no monument was set by this survey. See detail on page 1 of 1.

N 1/4 corner Section 25-736N-89E

The 1987 GLO survey established the corner as a post with the following bearing trees:

- 12" balsam N1645W 22.17E
- 12" hemlock S2930E 3.50'

The 1923-24 GLO completion survey confirmed the corner as a post, declared it the corner for Section 25 only, replaced the post with a 1" iron pipe and brass cap and reset the following bearing trees:

- 1924 bearing tree: 18" balsam S5730W 22.34'
- 1892 bearing tree: 18" hemlock S2930E 3.50'
- 1892 bearing tree in Section 24 was removed

This survey recovered no evidence of the original bearing trees or 1924 GLO monument. The position was computed by modified angle proportion between the S 1/4 corner and SE corner of Section 24. Set a 3/4" aluminum post with 3" aluminum USFS monument was set as a witness corner at the top of a small ridge at a point S27539E 114.30' from said position.

The following accessories for the WC were established by this survey:

- 22" hemlock N88E 23.16' (scribed 136N R9E S25 WC B7)
- 27" cedar N15W 6.03' (scribed 136N R9E S25 WC B7)

Accessories were set in Section 24 so that they will not be cut during logging efforts in Section 25.



C 1/4 corner Section 25-736N-89E

Set a 3/4" aluminum rod with 3" aluminum USFS monument (July 2010) stamped as shown and established the following accessories:

- 9" white fir N41W 13.52' (scribed C 1/4 S 25 B7)
- 26" white fir N61E 16.63' (scribed C 1/4 S 25 B7)

The corner falls N88E 04' from the northwest end of an existing bridge over Jackson Creek.

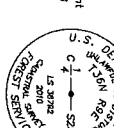

CN 1/16th corner Section 25-736N-89E

Set a 3/4" aluminum rod with 3" aluminum USFS monument (July 2010) stamped as shown and established the following accessories:

- 16" white fir S27W 25.39' (scribed CN 1/16 S 25 B7)



NE 1/16th corner Section 25-736N-89E

The calculated position falls in an unstable slide area and was not monumented. Set a 3/4" aluminum rod with 3" aluminum USFS monument (July 2010) stamped as shown as a witness corner at a point N872327W 30.58' from the calculated position and established the following accessories:

- 9" white fir N59W 22.08' (scribed WC NE 1/16 S 25 B7)
- 8" dogspur fir S74W 51.99' (scribed WC NE 1/16 S 25 B7)

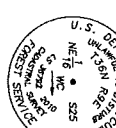

CE 1/16th corner Section 25-736N-89E

The calculated position falls in an unstable slide area and was not monumented. Set a 3/4" aluminum rod with 3" aluminum USFS monument (July 2010) stamped as shown as a witness corner at a point N871037W 45.00' from the calculated position and established the following accessories:

- 16" hemlock N31E 35.03' (scribed WC CE 1/16 S 25 B7)
- 28" hemlock N44W 20.85' (scribed WC CE 1/16 S 25 B7)



Witness corner # 1

Set a 3/4" aluminum rod with 3" aluminum USFS monument (July 2010) stamped as shown as a witness corner at a point N02330E 143.00' from the calculated position and established the following accessories:

- 28" hemlock S84W 10.64' (scribed WC CE 1/16 S 25 B7)
- no other trees in reasonable proximity to use for 2nd B7.



Witness corner # 2

Set a 3/4" aluminum rod with 3" aluminum USFS monument (July 2010) stamped as shown as a witness corner at a point N02330E 143.00' from the calculated position and established the following accessories:

- 28" hemlock S84W 10.64' (scribed WC CE 1/16 S 25 B7)
- no other trees in reasonable proximity to use for 2nd B7.

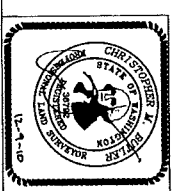
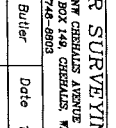

BUTLER SURVEYING INC.
 1715 NW CHESTNUT AVENUE
 SEASIDE, WA 98582
 509.746.8803

Drawn	C. Butler	Date	12-09-10
Checked	CS	Job No.	10-55
Scale	none	Sheet	2 of 2